



UNISEX BAGS  
**STAU773 - LIGHT TOTE BAG**

**Light Woven tote bag**

- Top edge double folded for strength and clean finish
- Long handles with reinforced cross stitch

Combo options

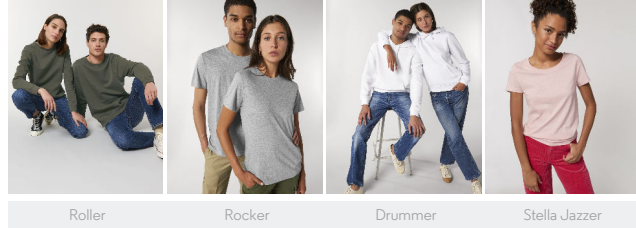

**WHITES**



**COLORS**



Shell : Plain Weave , 100% Cotton - Organic Ring Spun Combed , Fabric washed , 160 GSM

Printing Specifications

For suitable print techniques, please download our printing guide

Certifications & memberships



Wash Instructions

Wash similar colours together, no ironing on print, wash and iron inside out.



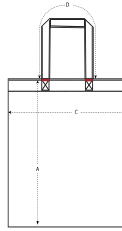

SIZES		OS
A	Height	42
C	Width	37
D	Strap Length	65

### PACKING

SIZES		OS
PCS/BAG		20
PCS/BOX		200